

Brake Disc Replacement Guide

This product must be fitted and used in accordance with the vehicle manufacturer's instructions.

We recommend that brake discs are replaced in pairs and new brake pads are fitted at the same time to ensure efficient and balanced braking. Excessive or high speed braking should be avoided, where practical during the first 400km, until the brakes are fully bedded in, to ensure maximum performance. The disc must be replaced when the minimum thickness of the disc is worn below the dimension indicated by MIN TH on the edge of the disc.

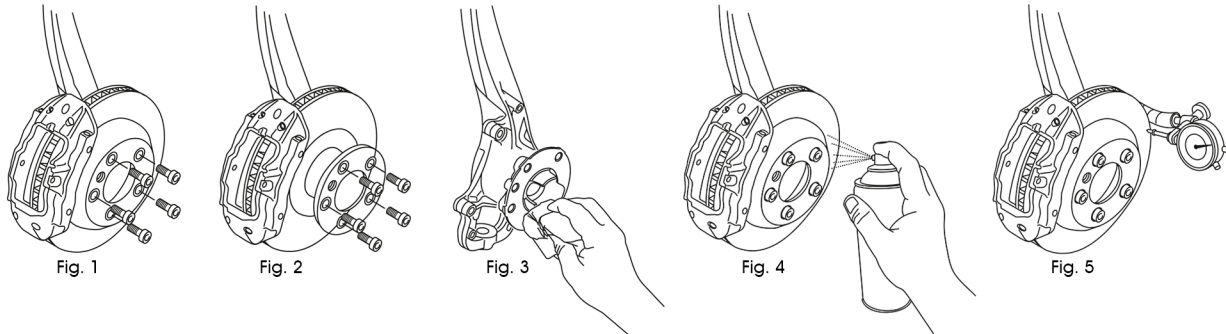

Brake Disc Replacement Instructions

1. Chock the wheels and apply the hand brake.
2. Loosen the wheel bolts or nuts.
3. Raise the vehicle in a safe and secure manner using appropriate lifting equipment.
4. Remove the road wheel.
5. Remove and support the brake caliper, avoiding stress or strain to the brake hose.
6. Depending on the disc / hub mounting design, remove the disc as follows:
 - a) Internal support type (see fig. 1) - Remove retaining screws, where fitted and remove the disc from the hub flange.
 - b) External support type (see fig. 2) - Undo and remove the wheel bearing retaining nut, then pull off the hub / disc assembly. Dismantle the disc from the hub.
7. Remove all traces of rust, dirt, or burrs from the mounting face of the hub flange. (see fig. 3). Failure to do so may invalidate the warranty.
8. Clean the protective oil coating off the new brake disc with a suitable solvent or brake cleaner fluid, ensuring the mounting face is free from dirt or burrs. (see fig. 4).
9. Assemble the brake disc onto the hub flange. with the external support design, adjust the wheel bearing in accordance with the manufacturer's specifications.
10. Check the "run out" of the disc using a dial gauge indicator (see fig. 5), measuring at the disc surface 15mm from the outer edge of the disc, whilst slowly rotating the disc. Alternatively use feeler gauges between a fixed point and the disc. Maximum disc run out should not exceed 0.15mm. When a higher reading is recorded, re-check items 7 and 8 and where possible rotate the disc on the mounting flange 180 degrees.
11. Re-assemble the brake caliper and fit new brake pads. Depress the brake pedal several times to ensure contact of the pads with the brake disc.
12. Replace the road wheel and tighten the wheel nuts to the correct torque settings.
13. Check brake fluid level.

After installing the new brake disc, it is strongly recommended to carry out a full dynamic balancing of the whole rotating assembly.